

## Electronic Throttle Controller Instrumentation

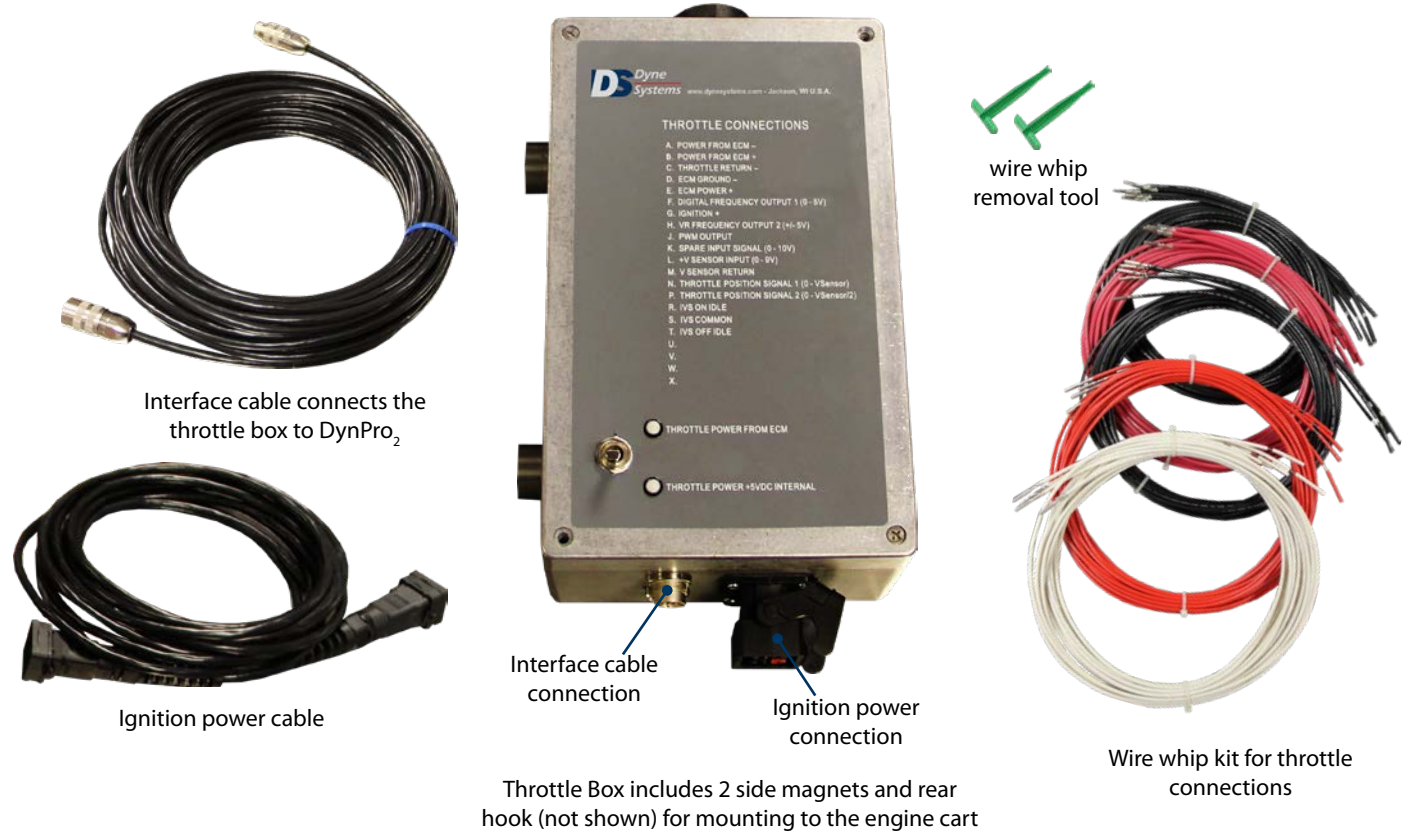

### Electronic Throttle Controller

The electronic interface connects directly to the vehicle or engine's harness and does not interfere with the vehicle's computers. Cable terminations or connections to the vehicle or engine's harness are the customer's responsibility. The interface uses a reference voltage and ground from the engine for operation. The control signal from the DynPro<sub>2</sub> system adjusts the throttle controller output proportionally.

#### Available Signals

- 0 - 2,000 Hz output (0 - 5 vdc and +/- 5 vdc) PWM
- 0 - 10 vdc Analog
- 4 - 20mA Current
- Frequency
- 0 - 5vdc + 0 - 2.5vdc (dual TPS)
- Idle validation switch output

*Everything you need to succeed*